



imageWARE
Enterprise Management Console
Version 4

Centralize Management of All Address Books

The Address Book Management (ABM) feature for imageWARE Enterprise Management Console lets you create address books for distribution to, and retrieval from, all supported imageRUNNER or imageRUNNER ADVANCE systems on your network.

Advantages of ABM:

- Centrally manage all imageRUNNER/imageRUNNER ADVANCE system address books to efficiently organize and control all address information in one location, thereby saving time and increasing productivity.
- Creating and deploying address books to multiple imageRUNNER/imageRUNNER ADVANCE systems eliminates the need to manually input and duplicate the same address book on each device.
- Retrieve multiple address books from any imageRUNNER/imageRUNNER ADVANCE system, then edit and deploy all to other imageRUNNER devices. This avoids having to edit each one individually before distribution.

SYSTEM REQUIREMENTS

- The Address Book Management feature must be used with imageWARE Enterprise Management Console and conform to the same system requirements.

Address Book Management Feature Workflow

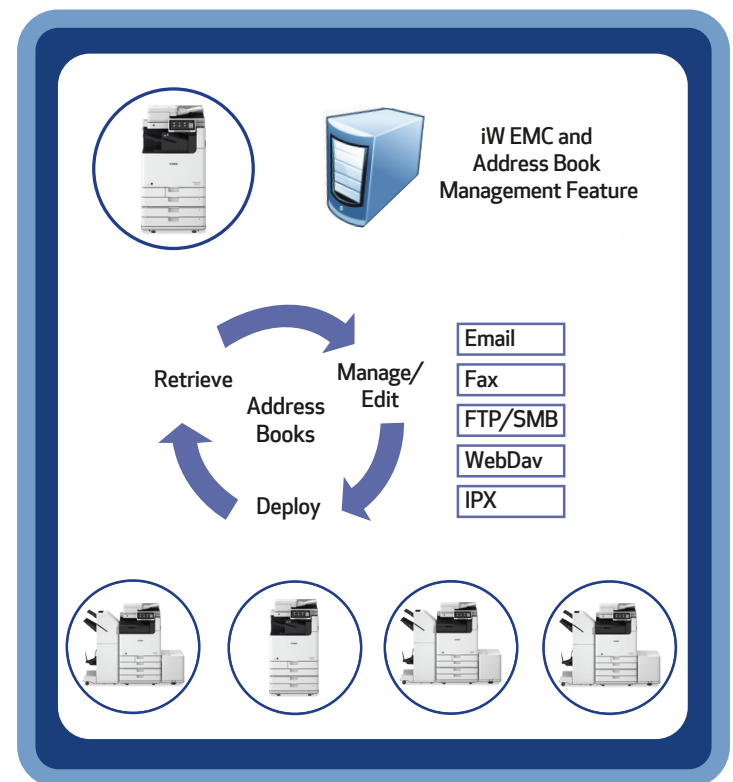

For more information about imageWARE Enterprise Management Console Address Book Management contact your local Canon Authorized Dealer.

 USA.CANON.COM/SOFTWARE

