



# Canon Laser Consumable Return Program





# Canon's Overview on the Environment



We at Canon are guided by the philosophy of *Kyosei* –living and working together for the common good. As a world-class leader in imaging technologies, we consider it our responsibility to protect and preserve valuable environmental resources. Canon seeks to be a truly excellent global corporation. For our customers, we offer the best products possible. Simultaneously, we strive to improve our relationships with local communities and to increase our respect for the environment as we contribute to the prosperity of the world and the happiness of its people.

Our company's commitment and contribution to the environment and to the world community are an integral part of Canon's management structure, product design, manufacturing, and corporate culture. This commitment has inspired many special corporate programs at both the global and regional level.

At Canon, we believe in living and working together into the future. We're committed to bringing you advanced technologies that run your business while respecting the global environment. For additional information on these programs please contact your Local Authorized Dealer. To learn more about other Canon environmental and community initiatives please visit:

[http://www.usa.canon.com/cusa/about\\_canon/community\\_environment](http://www.usa.canon.com/cusa/about_canon/community_environment)

In 1990, Canon became the first company to launch a recycling program for its cartridges. With the cooperation of its customers, Canon has collected more than 454,000 tons around the world. The goal of this program is to achieve zero landfill waste by reusing parts, recycling materials and employing energy recovery.

## So what happens at the Toner Cartridge Recycling Center?

Let the breaking down and sorting begin! Canon's all-in-one cartridges combine a photosensitive drum, charging unit, cleaner, and developing unit that can be reused. The toner cartridges are taken apart, sorted, and parts are then reused, recycled, or put through the energy recovery process. This process produces plastics, metals, and reconditioned parts that can be used in the manufacturing of new cartridges and other products. Absolutely no landfill waste is generated from the Canon Toner Cartridge!

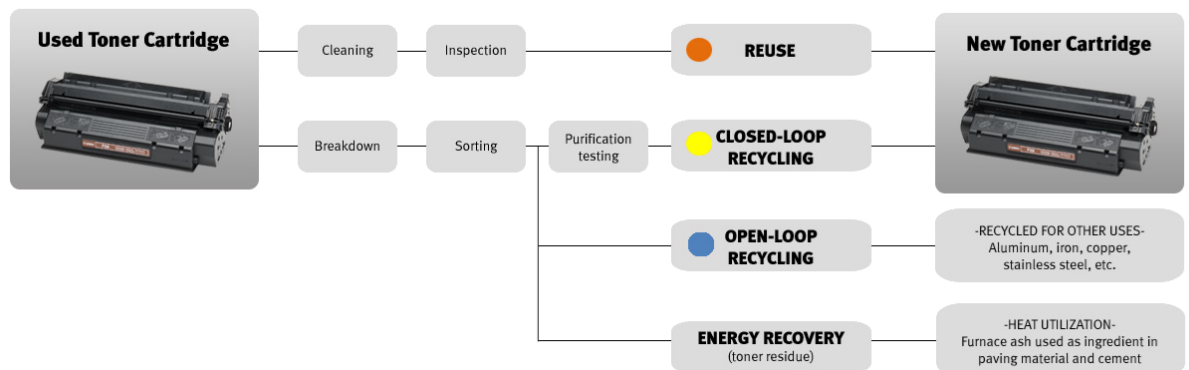
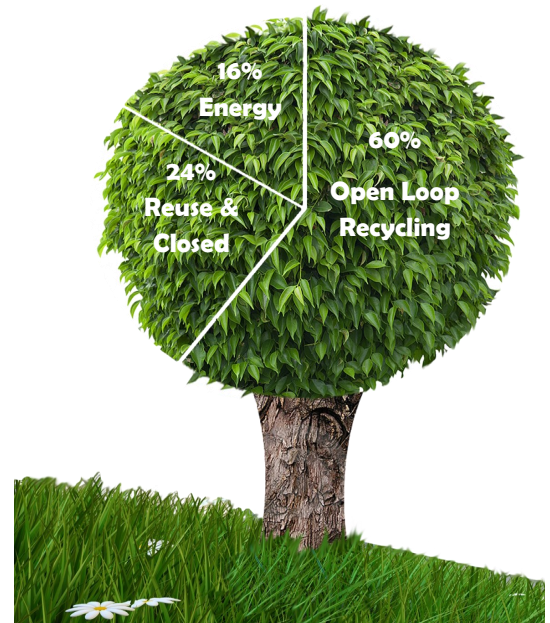
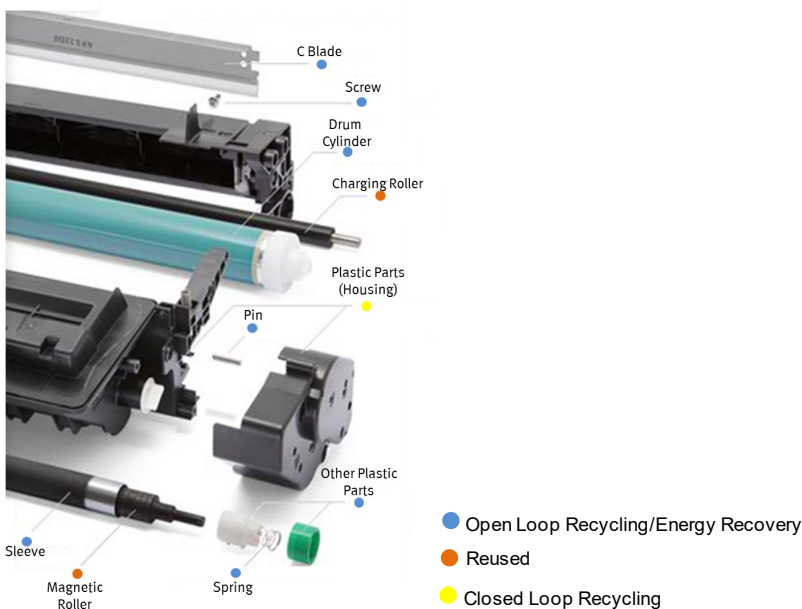



## TONER CONTAINER RECYCLING

The goal of recycling Toner Containers is to achieve zero landfill waste. Unlike Canon's all-in-one cartridges, toner containers are made mainly of plastic material, making local recycling and energy recovery possible.

### So what happens at the Canon Toner Container Recycling Center?

The toner containers are collected and sorted, and put through the recycling process. This process recycles at least 75% of toner and plastic and produces plastic flakes that can be used in the manufacturing of new cartridges, asphalt and other products. Absolutely no landfill waste is generated from the Canon Toner Container!



Start

Canon Toner Containers  
are sent to Canon's  
Recycling Center



Toner Containers are  
processed to generate  
clean, plastic flakes.



Pellets are then used  
for producing new  
cartridges and left over  
toner to make asphalt.

End



# Returning Canon Laser Consumable Supplies

## Think Globally, Recycle Locally

When local recycling is utilized, environmental impacts associated with the transportation of cartridges/containers are reduced. In the case that local recycling isn't an option, Canon has created alternative options for dealers and customers.

## Canon's Toner Recycling Center

When local recycling or energy recovery facilities are unable to accept toner supplies, Canon GENUINE toner containers, cartridges, and waste toner containers can be shipped to the Toner Container Recycling Center by Dealers or Customers.

### Canon Toner Recycling Center

5980 Industrial Drive

Gloucester, VA 23061

## Canon's Toner Recycling Center—Bulk Ship

When bulk orders are collected, customers can ship all toner cartridges/bottles and waste toner containers to the Canon Toner Recycling Center using a pre-paid shipping label\*. To generate the pre-paid shipping label, please visit: [http://www.usa.canon.com/tonercartridge\\_recycling](http://www.usa.canon.com/tonercartridge_recycling).

Bundle multiple Canon Brand consumable boxes together securely with tape.

Use your own large box to send bulk shipments for Canon Brand consumables.

When using the Bundled Box or Volume Box Return options, please be sure the shipment does not exceed UPS specifications:

- Maximum weight is 70 pounds
- Maximum length is 108 inches
- Maximum girth is 130 inches (length + 2 x width + 2 x height)

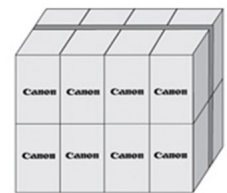

Bundle Shipping

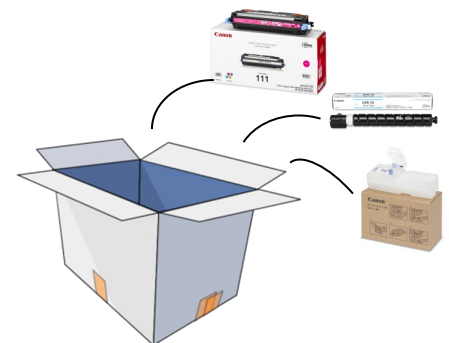

## Shipping Labels\*

Shipping labels for the Canon Laser Consumable Return Program can be generated on the Canon U.S.A. Website. To help conserve resources and reduce energy during transportation, Canon asks its customers to return more than one item in a box per shipping label. To generate a shipping label please visit: [http://www.usa.canon.com/tonercartridge\\_recycling](http://www.usa.canon.com/tonercartridge_recycling) or call 1800-OK-CANON.

\* Pre-paid labels can be used ONLY for acceptable Canon GENUINE brand cartridges/bottles and waste toner containers in the United States. For shipping details and restrictions, please visit the Canon U.S.A. website [http://www.usa.canon.com/tonercartridge\\_recycling](http://www.usa.canon.com/tonercartridge_recycling).

# Acceptable Canon Laser Consumable Supplies for Return

CRG-034 Cartridge/ Drum	CRG-039 Cartridge	CRG-039H Cartridge	CRG-040 L Cartridge	CRG-040 H Cartridge	CRG-041 Cartridge	CRG-041 H Cartridge	CRG-045 L Cartridge
CRG-045H Cartridge	CRG-046 L Cartridge	CRG-046H Cartridge	CRG 047 Cartridge	CRG 051 Cartridge	CRG 051 H Cartridge	CRG 052 Cartridge	CRG 052 H Cartridge
CRG 054 Cartridge	CRG 054 H Cartridge	CRG 055 Cartridge	CRG 055 H Cartridge	CRG 057 Cartridge	CRG 057 H Cartridge	CRG-067 Cartridge	CRG-067H Cartridge
CRG-069 Cartridge	CRG-069H Cartridge	CRG-071 Cartridge	CRG-071H Cartridge	CRG-101 Cartridge	CRG-102 Drum	CRG-103 Cartridge	CRG-104 Cartridge
CRG-105 Cartridge	CRG-106 Cartridge	CRG-107 Cartridge	CRG-108 Cartridge	CRG-110 Cartridge	CRG-110 II Cartridge	CRG-111 Cartridge	CRG-112 Cartridge
CRG-115 Cartridge	CRG-116 Cartridge	CRG-117 Cartridge	CRG-118 Cartridge	CRG-119 Cartridge	CRG-119 II Cartridge	CRG-120 Cartridge	CRG-121 Cartridge
CRG-125 Cartridge	CRG- 126 Cartridge	CRG- 128 Cartridge	CRG-131 Cartridge	CRG-131H Cartridge	CRG-137 Cartridge	CRG-324 Cartridge	CRG-324 II Cartridge
CRG- 332 Cartridge	A30 Cartridge	E20/E40 Cartridge	CRG-P Cartridge	PC Cartridge	EP-22 Cartridge	EP-25 Cartridge	EP-32 Cartridge
EP-52 Cartridge	EP-62 Cartridge	EP-72 Cartridge	EP-82 Cartridge/Drum	EP-83 Cartridge/Drum	EP-85 Cartridge	EP-86 Cartridge	EP-87 Cartridge/Drum
EP-A Cartridge	EP-E Cartridge	EP-H Cartridge/ Drum	EP-L Cartridge	EP-P Cartridge	EP-S Cartridge	EP-W Cartridge	F100 Cartridge
FX-1 Cartridge	FX-2 Cartridge	FX-3 Cartridge	FX-4 Cartridge	FX-5 Cartridge	FX-6 Cartridge	FX-7 Cartridge	FX-8 Cartridge
FX-11 Cartridge	GPR-1 Cartridge	GPR-7 Cartridge	GPR-28 Cartridge	GPR-29 Cartridge	GPR-40 Cartridge	GPR-41 Cartridge	GPR-44 Cartridge
GPR-45 Cartridge	L50 Cartridge	MP Cartridge 10	MP Cartridge 20	MP Cartridge 30	MP Cartridge 40	S35 Cartridge	X25 Cartridge
C120 Toner	C330D Toner	CLC 1100 Series Toner	CLC 5000/3900 Toner	CLC 700/800 Toner	CRG-102 Toner	GP200 Toner	GPR-2 Toner
GPR-4 Toner	GPR-5 Toner	GPR-6 Toner	GPR-8 Toner	GPR-9 Toner	GPR-10 Toner	GPR-11 Toner	GPR-12 Toner
GPR-13 Toner	GPR-15 Toner	GPR-16 Toner	GPR-17 Toner	GPR-18 Toner	GPR-19 Toner	GPR-20 Toner	GPR-21 Toner
GPR-22 Toner	GPR-23 Toner	GPR-24 Toner	GPR-26 Toner	GPR-27 Toner	GPR-30 Toner	GPR-31 Toner	GPR-32 Toner
GPR-33 Toner	GPR-34 Toner	GPR-35 Toner	GPR-36 Toner	GPR-37 Toner	GPR-38 Toner	GPR-39 Toner	GPR-42 Toner
GPR-43 Toner	GPR-48 Toner	GPR-51 Toner	GPR-53 Toner	GPR-53L Toner	GPR-54 Toner	GPR-55 Toner	GPR-55L Toner
GPR-56 Toner	GPR-57 Toner	GPR-58 Toner	GPR-61 Toner	GPR-61L Toner	GPR-63 Toner	GPR-74 Toner	IPQ-1 Toner
IPQ-2 Toner	IPQ-3 Toner	IPQ-4 Toner	NP1010/1020 Toner	NP6/7/8000 Toner	NPG-1 Toner	NPG-7	NPG-10
NPG-11 Toner	NPG-12 Toner	NPG-13A Toner	NPG-14 Toner	T01 Toner	T02 Toner	T03 Toner	T04 Toner
T04L Toner	T06 Toner	T07 Toner	T11 Toner	T14 Toner	Canon Waste Toner Containers	varioPRINT Toners	VP6000 Toner
Toner 3001							

\* Only Canon GENUINE Cartridges/Containers listed above are acceptable for return. No third party, remanufactured or refilled supplies of any kind will be accepted. Any unauthorized use may result in the return to sender at sender's expense.



# Reduce, Reuse, Recycle

**Canon**

1-800-OK-CANON

[www.usa.canon.com](http://www.usa.canon.com)

Programs and services are subject to change without notice. CANON and the GENUINE LOGO are registered trademarks of Canon Inc. in the United States and may be registered trademarks or trademarks in other countries.

© 2023 Canon U.S.A., Inc. All rights reserved.

April 2024

Version 12.AMP

Canon U.S.A., Inc.

One Canon Park

Melville, NY 11747

 **CANON**  
**GENUINE**  
TONER, CARTRIDGE  
& PARTS